

Channel Cable Tray

Straight Sections

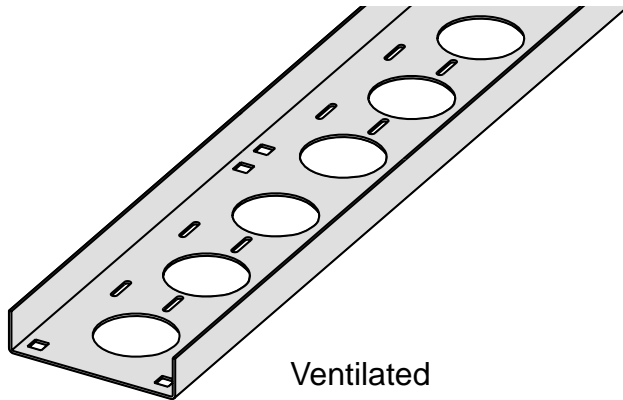

Ventilated

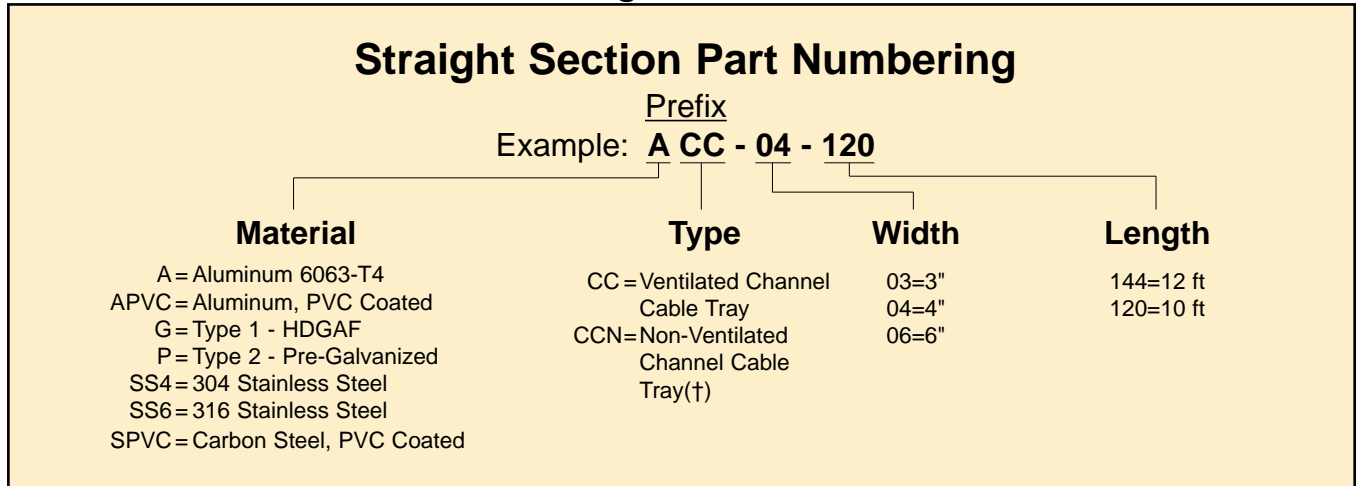
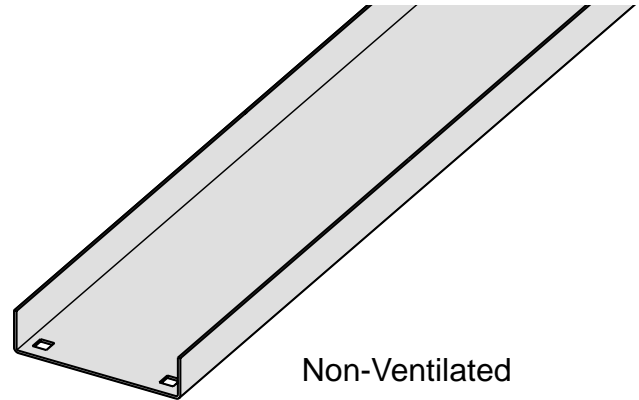

Non-Ventilated

Ventilated straight sections contain 2¹/₄" (57mm) diameter holes and 3³/₁₆" (5mm) x 7⁷/₈" (22mm) slots for cable attachment. Ventilated straight sections also have splice holes repeating every 12" (305mm) to simplify field modifications.

Mtl. Type	Width in.	Depth in.	UL Area in ²	Load Data * Safety Factor = 1.5	Support Span (ft)				Load Data * Safety Factor = 1.5	Support Span (m)			
					5	6	10	12		1.5	1.8	3.0	3.7
Aluminum	3 (75)	1.25 (32)	0.06	Load (lbs/ft)	22	15	5	4	Load (kg/m)	32	22	8	6
				Deflection Multiplier	0.025	0.051	0.395	0.820	Deflection Multiplier	0.422	0.874	6.747	13.990
	4 (100)	1.75 (44)	0.06	Load (lbs/ft)	48	33	12	8	Load (kg/m)	71	49	18	12
				Deflection Multiplier	0.0071	0.015	0.114	0.236	Deflection Multiplier	0.122	0.252	1.945	4.033
	6 (150)	1.75 (44)	1.00	Load (lbs/ft)	52	36	13	9	Load (kg/m)	77	54	19	13
				Deflection Multiplier	0.0055	0.011	0.088	0.183	Deflection Multiplier	0.0939	0.195	1.503	3.117
Steel 14 Gauge	3 (75)	1.25 (32)	0.20	Load (lbs/ft)	24	17	6	4	Load (kg/m)	36	25	9	6
				Deflection Multiplier	0.013	0.028	0.216	0.447	Deflection Multiplier	0.230	0.477	3.677	7.625
	4 (100)	1.75 (44)	0.40	Load (lbs/ft)	52	36	13	9	Load (kg/m)	77	54	19	13
				Deflection Multiplier	0.0039	0.0082	0.063	0.130	Deflection Multiplier	0.0671	0.1391	1.074	2.226
	6 (150)	1.75 (44)	0.40	Load (lbs/ft)	59	41	15	10	Load (kg/m)	88	61	22	15
				Deflection Multiplier	0.0030	0.0063	0.049	0.101	Deflection Multiplier	0.0518	0.1074	0.829	1.719

To calculate simple Beam Deflection in inches, multiply the design load (lbs/ft) by the Deflection Multiplier shown for the span.
 To calculate simple Beam Deflection in millimeters, multiply the design load (kg/m) by the Deflection Multiplier shown for the span.
 All dimensions in parenthesis are millimeters, unless otherwise specified.

* Load data is determined by realistic deflection, not by failure.

† Not recognized by the NEC®

Channel Cable Tray

Accessories

Splice Plate

The Splice Plate has the standard 4-hole pattern for all channel cable tray.

- Provided with straight sections and fittings.
- Furnished as one plate with hardware.
- (*) Insert A, G, P, SS4, SS6

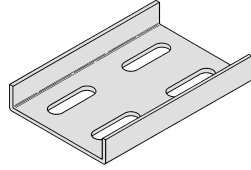

Catalog No.	Channel Width	
	in.	(mm)
9(*)-1043	3	(76)
9(*)-1044	4	(101)
9(*)-1044-6	6	(152)

Blind End Plate

The Blind End Plate forms a closure for any channel cable tray dead end.

- Furnished as one plate with hardware.
- (*) Insert A, G, P, SS4, SS6

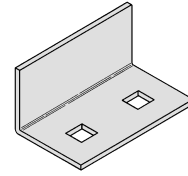

Catalog No.	Channel Width	
	in.	(mm)
9(*)-1583	3	(76)
9(*)-1584	4	(101)
9(*)-1586	6	(152)

Horizontal Adjustable Splice Plate

The Horizontal Adjustable Splice Plate adapts to changes in direction in a horizontal plane, beyond the capability of the standard horizontal fittings.

- Furnished as one plate with hardware.
- (*) Insert A, G, P, SS4, SS6

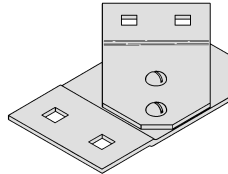

Catalog No.	Channel Width	
	in.	(mm)
9(*)-1743	3	(76)
9(*)-1744	4	(101)
9(*)-1746	6	(152)

Vertical Adjustable Splice Plate

The Adjustable Splice Plate allows changes in elevation where standard vertical fittings are not applicable.

- Furnished as one plate with hardware.
- (*) Insert A, G, ZN, SS4, SS6

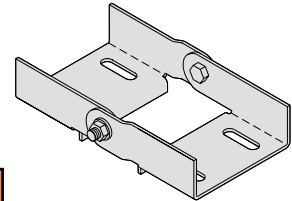

Catalog No.	Channel Width	
	in.	(mm)
9(*)-1643	3	(76)
9(*)-1644	4	(101)
9(*)-1646	6	(152)

Box Connector

The Box Connector is used to attach the end of a channel cable tray run to a distribution box or a control center.

- Furnished as one connector with hardware.
- (*) Insert A, G, P, SS4, SS6

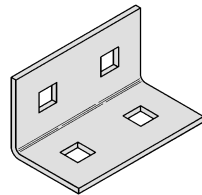

Catalog No.	Channel Width	
	in.	(mm)
9(*)-1543	3	(76)
9(*)-1544	4	(101)
9(*)-1546	6	(152)

Channel To Tray or Channel To Channel Connector

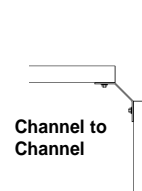
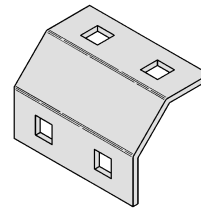

Channel to Tray

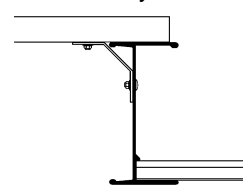

Catalog No.	Channel Width	
	in.	(mm)
9(*)-1261-3	3	(76)
9(*)-1261-4	4	(101)
9(*)-1261-6	6	(152)

The Channel Connector is used to link a channel cable tray to a cable tray, or a channel cable tray to channel cable tray.

- Furnished as one plate with hardware.
- (*) Insert A, G, P, SS4, SS6

Channel Reducer Plate

The Channel Reducer Plate is used to join channel cable tray sections of different widths.

- Furnished as one plate with hardware.
- (*) Insert A, G, P, SS4, SS6

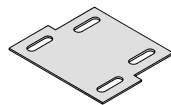

Catalog No.	Channel Width	
	in.	(mm)
9(*)-1843	4 to 3	(101 to 76)
9(*)-1863	6 to 3	(152 to 76)
9(*)-1864	6 to 4	(152 to 101)

Mounting Bracket - Channel To Tray

The Mounting Bracket allows a parallel run of channel cable tray to be attached to the side of a cable tray. It can also serve as a support splice connection.

- Furnished as one bracket.
- Order hardware separately.
- (*) Insert A, G, ZN, SS4, SS6

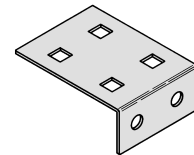

Catalog No.	Channel Width	
	in.	(mm)
9(*)-1237-3	3	(76)
9(*)-1237-4	4	(101)
9(*)-1237-5	6	(152)



All dimensions in parenthesis are millimeters unless otherwise specified.

Channel Cable Tray

Accessories

Expansion Guide Clamp

The Expansion Guide Clamp allows channel cable tray to expand and contract in the horizontal plane, but not in the transverse plane.

- Furnished as one clamp.
- Order 1/2" hardware separately.
- (*) Insert A, G, ZN, SS4, SS6

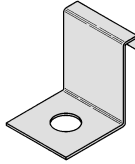
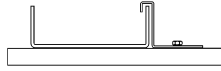

Catalog No.	Channel Width	
	in.	(mm)
9(*)-1243	3	(76)
9(*)-1244	4	(101)
9(*)-1244	6	(152)

Hold-Down Clamp

The Hold-Down Clamp secures channel cable tray to a support member.

- Furnished as one clamp.
- Order 1/2" hardware separately.
- (*) Insert A, G, ZN, SS4, SS6

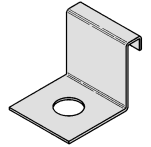
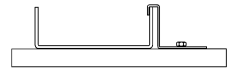

Catalog No.	Channel Width	
	in.	(mm)
9(*)-1245	3	(76)
9(*)-1246	4	(101)
9(*)-1246	6	(152)

Channel To Floor Base Plate

The Channel to Floor Base Plate is used to attach the end of a channel cable tray run to the floor or to an equipment mounting pad.

- Anchors and hardware are ordered separately.
- (*) Insert A, G, ZN, SS4, SS6

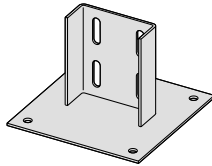

Catalog No.	Channel Width	
	in.	(mm)
9(*)-3305-3	3	(76)
9(*)-3305-4	4	(101)
9(*)-3305-6	6	(152)

Channel Cable Tray Bushing

The Channel Cable Tray Bushing is a snap-in plastic bushing used to protect cable insulation from mechanical wear.

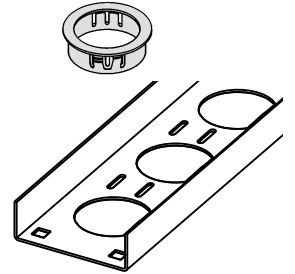

Catalog No.	99-1125
-------------	---------

Channel Cable Tray Brackets

- Finishes available: ZN, G

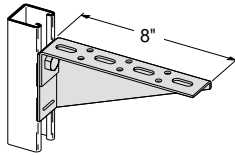

Catalog No.	Channel Width	
	in.	(mm)
B185CCL	3	(76)
	4	(101)
	6	(152)

Channel Cable Tray Brackets

- Finishes available: ZN, G, GRN

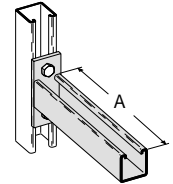

Catalog No.	Channel Width		A	
	in.	(mm)	in.	(mm)
B409-6	3	(76)	6	(152)
B409-9	4, 6	(101, 152)	9	(228)

Channel Cable Tray Hangers

Designed for 1/2 Threaded Rod

Single Channel Cable Tray Hanger

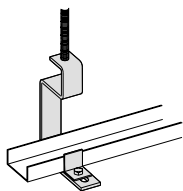

150 lb (.67kN)
Safety Factor 3.0

Material	Channel Width											
	in.		(mm)		in.		(mm)					
Zinc Plated Steel	3		(76)		4		(101)		6		(152)	
	9ZN-1232-3		9ZN-1231-3 & 4		9ZN-1232-4		9ZN-1231-3 & 4		9ZN-1232-6		9ZN-1231-6	
HDGAF Steel (18 Ga.)	3		(76)		4		(101)		6		(152)	
	9G-1232-3		9G-1231-3 & 4		9G-1232-4		9G-1231-3 & 4		9G-1232-6		9G-1231-6	

Double Channel Cable Tray Hanger

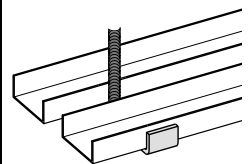

265 lb (1.18kN)
Safety Factor 3.0

Channel Cable Tray

Accessories

Channel Cable Tray Connectors

Fast, economical, space saving Channel Cable Tray Connectors
 Patent No. 5,628,481; 5,782,439. Other patents pending.

Horizontal:

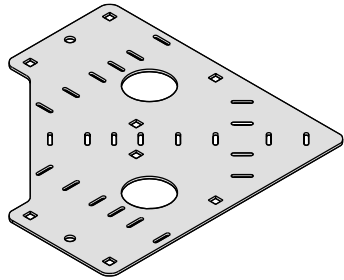
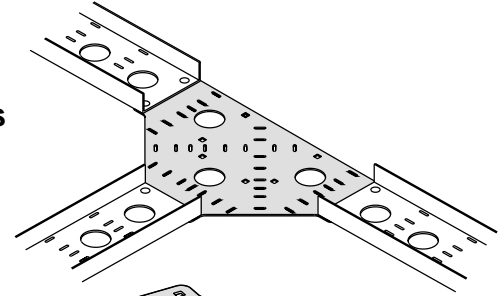

90° Bend

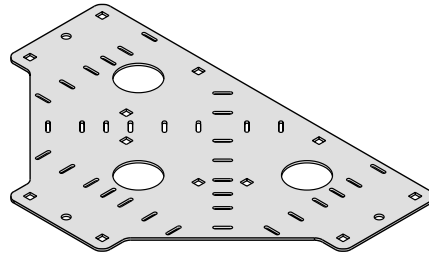

Tee

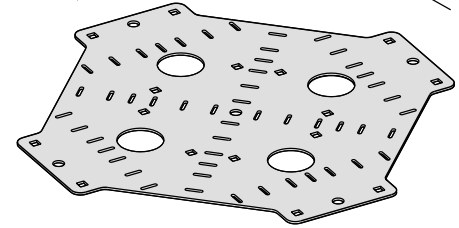

Cross

- Provides 0 or 6-inch radius connection for Channel Cable Tray
- The Pivot Connector is available for custom angle adjustment
 - up to +/- 45° angle adjustment
 - order the desired quantity separately
- Slotted for easy cable fastening
- Shipped with the required hardware

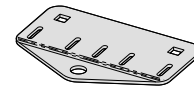

Pivot Connector

(See page 74 of the Installation Suggestions)

Vertical:

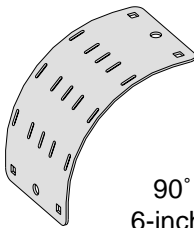

90° Bend
6-inch radius

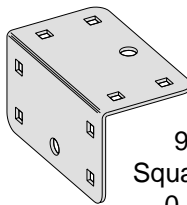

90° Vertical
Square Connector
0-inch radius

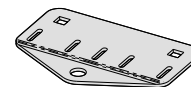

Pivot Connector

(See page 74 of the Installation Suggestions)

- Use the same part for VO and VI applications
- Slotted for easy cable fastening
- The Pivot Connector is available for custom angle adjustment (order separately)
- Shipped with the required hardware

See Cable Tray Systems Catalog (CT-01) for standard fittings and covers

Connector Part Numbering

Prefix

Example: **A CC - 04 - 90HC 060**

Material

A=Aluminum
G=Type 1 HDGAF

Tray Type

CC=Ventilated
Channel Cable Tray

Width

03=3"
04=4"
06=6"

Connector Type

90HC=90° Horizontal
HTC=Horizontal Tee
HXC=Horizontal Cross
90VC=90° Vertical
PC=Pivot Connector

Radius

Horizontal Connectors
060=0" & 6" Radii
Vertical Connectors
00=0" Radius
06=6" Radius